

Architectural & Engineering Specifications (A & E)

Sealed Outdoor Camera Enclosure universally Compatible with most brand and models of IP and analog PTZ and Mini-Dome Camera.

PRODUCTS

1.00 MANUFACTURER

- A. Dotworkz, Inc.
3688 Midway Drive
San Diego, CA 92110
PH. +1 (866) 575-4689
FAX +1 (619) 639-9914
- B. This product shall be manufactured in the USA using the highest quality.

1.02 GENERAL CAMERA ENCLOSURE DESCRIPTION

- A. Camera Enclosure specified shall be designed for Ethernet network cameras & CCTV cameras for commercial, industrial, or government applications requiring a rugged, sealed outdoor rated camera enclosure with compatibility to house a broad range of Pan Tilt Zoom (PTZ) or fixed Mini-dome cameras that are commercially available for IP, and High Definition, and CCTV capability.
- B. Camera Enclosure shall be minimal outdoor protection rating of IP66 and/or NEMA 4X and shall include harsh environment IP68 or better cable seal strain relief connector ports.
- C. Customer supplies camera to be installed into the enclosure.

D2-HB-MVP Outdoor Housing

Dotworkz D2 Heater Blower Outdoor Enclosure for Surveillance Camera Systems

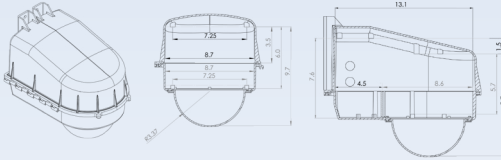

1.03 CAMERA ENCLOSURE REQUIREMENTS

- A. Shall provide power to compatible cameras @ 12 VDC & 24 V, and environmental control board for providing power to protective elements, including a thermostatically controlled active 25 watt heater & blower fan.

1.04 ENCLOSURE MOUNTING REQUIREMENTS

- A. Shall have integrated capacity for wall mounting of enclosure.
- B. Shall be compatible with optional brackets with capacity for strap mounting pole mounting of enclosure, corner mounting bracket options, and parapet mounting options, and non-penetrating roof mounting.
- C. Shall be compatible with a media connection cable of Category 5 and/or Category 5 Enhanced and/or Category 6 twisted pair (UTP) cable, or analog coaxial cable.

2.00 Electrical Specification

- A. Source Supply Voltage to power enclosure: 95-264VAC & 20-30VAC/ VDC.
- B. Voltage available inside enclosure to power Camera: 12VDC @ 25 watts max, or 24V @ 25 watts max.
Total sum power to camera or accessories is 25 watts; each channel.

2.01 Mechanical Specifications - Housings

- A. Weight: 7.5 lbs. (3.4 kg)
- B. Exterior 14.9(L) x 13.4(H) x 11.7”(W)
- C. Interior: 8.6 (dia @ mount base) x 9.3 tall (6.8 dia. max @ lens) (Maximum camera size)
- D. Hinged Lower with Captive Stainless Steel Fasteners.
- E. Rugged Polycarbonate Housing (0.160” wall).
- F. Clear Acrylic Viewing Lens bubble 6.8” dia. x 3.7” deep.
- G. White Semi-gloss finish to PC housing.
- H. Protective Urethane foam Gasket Seals.
- I. Integrated wall mounting tabs.
- J. Integrated Omni Antennae mounting tab on side.
- K. Certifications: NEMA 4X / IP66.

2.02 Environmental Specifications

- A. Operating Temperature Range: -20°F to 145°F (-29°C to 63°C).
- B. Humidity: 10% to 90% non-condensing.
- C. Housing Shall meet or exceed a rating of NEMA 4X and/or IP66.
- D. Shall have two cable entry ports rated to IP67 for power & data cables.
- E. Shall be deployable into a wide range of moderate environments of Residential, Commercial, Industrial, Marine, Desert, and other indoor & outdoor installations.